

Product Datasheet

27-port Gigabit Uplink Non-standard PoE Switch

(GWS-2024PFS)



Overview

The GWS-2024PFS is an unmanaged PoE switch independently developed by HZGWS. It has 24*10/100M Base-T PoE ports, 2*10/100/1000M Base-T uplink RJ45 ports and 1*1000M Base-X uplink SFP ports. Port 1-24 can support 24V non-standard PoE power supply. Single-port PoE power up to 24W. As a non-standard PoE power supply device, it must be connected to the corresponding non-standard electrical equipment (such as wireless bridge and Video Door Phone), or the corresponding non-standard separation line to convert, and then achieve the PoE power supply. It can supply power to various adaptable terminals through network cables to meet the demand for high density PoE power supply network environment. It is suitable for hotels, campuses, factory dormitories, and small and medium-sized enterprises to establish cost-effective networks. Unmanaged mode, plug and play, no configuration, easy to use.

Feature

■ 100Mbps access, Gigabit optical ports uplink

- ◇ Support non-blocking wire-speed forwarding for smoother transmission.
- ◇ Support IEEE 802.3x full-duplex flow control and Backpressure half-duplex flow control.
- ◇ Provide Ethernet ports and Gigabit SFP ports uplink for flexible networking and meets the networking requirements of various scenarios.

■ Intelligent PoE power supply

- ◇ 24*10/100Base-TX RJ45 ports support 24V PoE power to meet the needs of PoE power in various scenarios in the security field, Single-port PoE power up to 24W.
- ◇ It can quickly realize the power supply function of POE cable through the two ways of switching directly to non-standard electrical equipment or switch and non-standard separation line.

■ Stable and reliable

- ◇ CCC,CE, FCC, RoHS.
- ◇ Low power consumption, galvanized steel casing, no fan.
- ◇ Self-developed power supply, high redundancy design, providing a long term and stable PoE power output.

■ easy to use

- ◇ Plug and play, no configuration, simple and convenient.
- ◇ **Long-distance mode (E):** switch to "ON" position (default "OFF"), the port 17 to 24 rate is 10M, Using the existing twisted pair can break through the 100 meters transmission limit, and the transmission distance can be up to 250 meters. At the same time, it can solve the problem of poor transmission caused by aging lines.
- ◇ The user-friendly panel can show the device status through the LED indicator of PWR, Link, PoE.

Technical Specification

Model	GWS-2016PFS	GWS-2024PFS
Interface Characteristics		
Fixed Port	16*10/100Base-T PoE ports (Data/Power) 2*10/100/1000Base-T uplink RJ45 ports (Data) 1*1000Base-X uplink SFP ports (Data)	24*10/100Base-T PoE ports (Data/Power) 2*10/100/1000Base-T uplink RJ45 ports (Data) 1*1000Base-X uplink SFP ports (Data)
Ethernet Port	Port 1-16/1-24 can support 10/100Base-T(X) and 17-18/25-26 can support 100/1000Base-T(X) automatic detection, full/half-duplex MDI/MDI-X auto-sensing	
Twisted Pair Transmission	10BASE-T: Cat3,4,5 UTP(≤250 meter) 100BASE-TX: Cat5 or later UTP(≤100 meter) 1000BASE-T: Cat5e or later UTP(≤100 meter)	
Optical Fiber Port	Gigabit optical fiber port, default no include optical module(optional order single-mode / multi-mode, single fiber / dual fiber optical module. LC/SC)	
Optical Cable/ Distance	Multi-mode: 850nm/ 0-550m Single-mode: 1310nm/ 0-40km, 1550nm/ 0-120km	
Functional Switch	E : long-distance function (Default: OFF, Use:ON), After opening, ports 9-16/17-24 support 10M/250m long distance	
Chip Parameter		
Network Protocol	IEEE802.3 10BASE-T, IEEE802.3i 10Base-T IEEE802.3u 100Base-TX, IEEE802.3ab 1000Base-T, IEEE802.3z 1000Base-X, IEEE802.3x	
Forwarding Mode	Store and Forward(Full Wire Speed)	

Switching Capacity	9.2Gbps (Non-blocking)	10.8Gbps (Non-blocking)
Forwarding Rate@64byte	6.84Mpps	8.04Mpps
MAC	2K	2K
Buffer Memory	2.75M	
Jumbo Frame	9.2K	
LED Indicator	Power: PWR (Green), Network: Link (Green), PoE: PoE (Red), Functional switch: EXTEND (Green)	
PoE & Power Supply		
PoE Port	Port 1 to 16 support 24V POE+ power supply	Port 1 to 24 support 24V POE+ power supply
Power Supply Pin	4/5(+) 7/8(-)	
Max Power Per Port	24W, non-standard PoE+	
Total PWR / Input Voltage	180W/ (AC100-240V)	280W/ (AC100-240V)
Power Consumption	Standby <5W, Full load <180W	Standby <8W, Full load <250W
Power Supply	Built-in power supply, AC100~240V 50-60Hz 2.2A	Built-in power supply, AC100~240V 50-60Hz 4.1A
Physical Parameter		
Operation TEMP / Humidity	-20~+55°C, 5%~90% RH Non condensing	
Storage TEMP / Humidity	-40~+80°C, 5%~95% RH Non condensing	
Dimension (L*W*H)	350*215*44mm	350*215*44mm
Net /Gross Weight	<2.3kg / <2.8kg	<2.5kg / <3.0kg
Installation	Desktop, Rack-mounted	
Certification & Warranty		
Lightning Protection	Lightning protection: 4KV 8/20us, Protection level: IP30	

Certification	CCC, CE mark, commercial, CE/LVD EN62368-1, FCC Part 15 Class B, RoHS
Warranty	1 year, lifelong maintenance.

Dimension

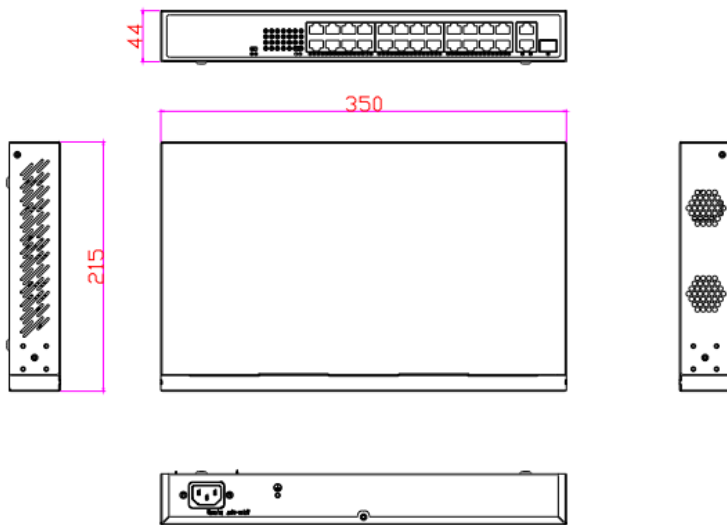

Application

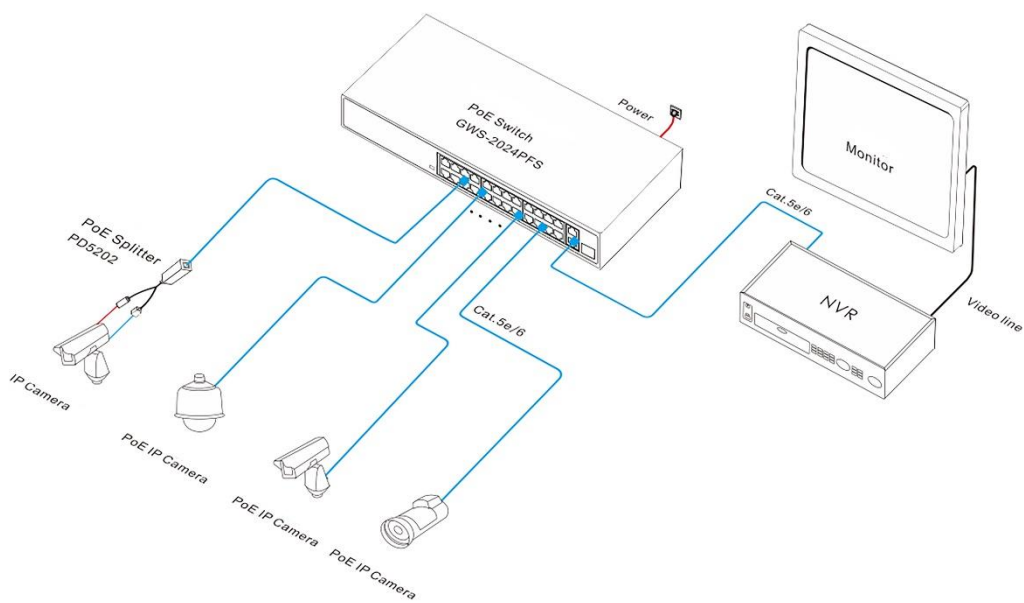

Ordering Information

Model	Description	Power Supply
GWS-2016PFS	Unmanaged PoE switch with 16*10/100M PoE ports, 2*10/100/1000M Base-T uplink RJ45 ports and 1*1000Base-X uplink SFP ports,non-standard PoE switch, port 1-16 can support 24V non-standard PoE+. Adjust the functional switch, can realize 9-16 ports 10M/250 meters extend transmission. Built-in power supply.	24V/180W
GWS-2024PFS	Unmanaged PoE switch with 24*10/100M PoE ports, 2*10/100/1000M Base-T uplink RJ45 ports and 1*1000Base-X uplink SFP ports,non-standard PoE switch, port 1-24 can support 24V non-standard PoE+. Adjust the functional switch, can realize 17-24 ports 10M/250 meters extend transmission. Built-in power supply.	24V/280W

Packing List

	CONTENT	QTY	UNIT
Packing List	27-port Gigabit Uplink Non-standard PoE Switch	1	SET
	AC Power Line	1	PC
	User Guide	1	PC
	Warranty Card	1	PC

Contact Us



Tel: 0086-752-3397806

WeChat: HZGWS--PoE

Email: hzgws@hgzws.com

Skype: [hzgws@hgzws.com](https://www.skype.com/people/hzgws@hgzws.com)

Website: www.hzgws.com

Address: Building 3, Phase II, Xinghe Artificial Intelligence Industrial Park, No.333 Zhongkai 6th Road, Chenjiang Street, Zhongkai High-tech Zone, Huizhou

